X-MEDIA DREAMBOX

View High Resolution TV/Video on PC monitor

Package Included:

- X-media DreamBox
- Infra Remote Control
- 2 x 'AAA' size Batteries
- 5' VGA Extended Cable
- 5' Audio Extended Cable
- AC / DC-12V Power Adapter

Welcome!

Thank you for purchasing the X-media DreamBox!

With this X-media DreamBox, you can turn your RGB monitor or LCD display panel into a TV with or without even having to turn on your computer. Just plug it into your monitor or LCD display and you're ready to watch TV, DVD, RCA programs, or play video games. X-media DreamBox is completely plug-n-play. This is no software driver required.



CAUTION

You are cautioned that any changes or modifications not expressly approved in this manual could void your authority to operate this equipment.

If not installed and used in accordance with the instructions, this equipment may cause corrupt interference to radio communications. However, there is no guarantee that interference will not occur in a particular installation. If this equipment does cause equivocal interference to radio or telephone reception, which can be determined by turning the equipment off and on, the user is encouraged to try to correct the interference by one or more of the following measures:

- Reorient or relocate the TV antenna if there is any.
- Increase the separation between the equipment and Telephone reception.
- Connect the equipment into an outlet on a circuit different from that to which the radio receiver is connected.
- Consult the dealer or an experienced radio/Telephone technician for help.

About operating voltage

Operate the unit with the appropriated on the outer packaging and where AC Adapter (Class II Transformer) connect with the AC power outlet. It will be one of the following:

- DC 12V - 1000mA

About installation

Do not place the unit near heat sources, rain, moisture or mechanical shock, and ensure that there is nothing to interfere with proper ventilation/airflow.

IMPORTANT SAFETY INSTRUCTION

1. Read these instructions.
2. Keep these instructions.
3. Heed all warnings.
4. Follow all instructions.
5. Do not use this apparatus near water.
6. Clean only with a damp cloth.
7. Do not block any of the ventilation openings. Install in accordance with the manufacturer's instructions.
8. Do not install near any heat sources such as radiators, heat registers, stoves, or other apparatus (including amplifiers) that produce heat.
9. Protect the power cord from being walked on or pinched particularly at plug, convenience receptacles, and the point where they exit from the apparatus.
10. Only use attachments/accessories specified by the manufacturer.
11. Refer all servicing to qualified service personnel. Servicing is required when the apparatus has been damaged in any way, such as power-supply cord or plug is damaged, liquid has been spilled or objects have fallen into the apparatus, the apparatus has been exposed to rain or moisture, does not operate normally, or has been dropped.

WARNING: To reduce the risk of fire or electric shock, do not expose this apparatus to rain or moisture.



Contents

FEATURES.....	4
SPECIFICATION.....	5
BOX UNIT [F].....	5
BOX UNIT [R].....	6
BASIC CONNECTION.....	6
OPTIONAL CONNECTION.....	7
REMOTE CONTROL.....	9
OSD MENU.....	10
VIDEO 1.....	10
VIDEO 2.....	10
AUDIO.....	11
CLOCK.....	11
SETUP.....	12
SVGA.....	12
TV.....	13
PANEL CONTROL.....	13
TROUBLESHOOTING.....	14
GLOSSARY.....	14
LIMITED WARRANTY.....	17
LIMITED NINETY (90) DAY WARRANTY.....	17
LIMITED ONE (1) YEAR WARRANTY.....	17
RENTAL UNITS.....	17
COMMERCIAL UNITS.....	18
REGISTER PRODUCT.....	18
YOUR RESPONSIBILITY.....	18
IMPORTANT : PACKAING AND SHIPPING INSTRUMENT.....	19



FEATURES:

- Watch TV or Video without Turning on your computer
- Compatible with all VGA, LCD, and Mac monitors
- Plug-n-Play! No software drivers required
- Play your favorite games with consoles like Nintendo[®], Sega[®], Dreamcast[™] and Play Station 2[®], X-Box[®], etc.
- Full screen, or size-selectable windows display on monitor
- Easily switch to TV, Video or PC display
- Full functional infrared Remote Control
- Built-in Touch Button Control Panel
- Auto-scan, to memorized all active TV channels line up in your area
- Support 125 Channels
- On-Screen Display (OSD) Menu
- Sleep/Alarm/Timer Setup function
- Brightness/Contrast/Hue/Color/Saturation adjustment
- Available interpretation in NTSC or PAL
- Supports 640x480@60Hz, 640x480@72Hz, 800x600@60Hz, 1024x768@60Hz resolution and refresh rate for video output

Imagine turning your regular PC into the best multimedia entertainment system! X-media DreamBox uses the latest De-Interlacing method, which delivers superior image and picture quality. X-media DreamBox not only allows you to watch TV or video, but also comes with input connectors to hook up with a VCR for playing video tape. In addition, the AV, S-Video and RCA input allow you to connect with a Nintendo, Sega, Dreamcast or Play Station 2 for the exciting video games for your computer.

Furthermore, you can choose either the full screen function that will give you the maximum TV viewing experience, or the ... size overlay window which keeps your favorite TV or soap opera on anytime even during your most busies working hour. Other unique features including support up to 1024x768 display resolution, multi-lingual on-screen display (OSD), sleep timer functions, and more.



X-media DreamBox and Remote Control

Your Packaging may also contain other printed material with special offers for direct purchase of related products as well.



Specification

Physical Dimension:	Width = 8 □", Height = 2 □", Depth = 6" (Box only)
TV Program Source:	<ul style="list-style-type: none"> ■ TV Antenna (75Ω) ■ Cable TV (Coaxial)
Input Video Source:	<ul style="list-style-type: none"> ■ Video Camcorder ■ VCR ■ DVD Player ■ Video Game Console
Input Audio Source:	- PC Sound Card
Video Output:	VGA out (DB 15) - Output: <ul style="list-style-type: none"> • RGB Monitor • Analog LCD Monitor
AC Adapter:	AC-120V, 60Hz / DC - 12V 1000mA (Class 2 Transformer)
Audio Output:	- Speakers (with Amplifier built-in) (Not included)
Video Signaling:	NTSC / PAL NTSC (Default setting)
TV Signaling:	NTSC (Model # 91007N) PAL (Model # 91007P)

Note: All dimensions are Inches, otherwise may specified. Feature and specification are subject to change without notices.

Box Unit [F]

Front Side

The touch button panel on the front side of the X-media DreamBox provides quick access to commonly used functions.

- Power - Turn the unit on / off
- LED - Indicate the power is on (Green) or off (Orange)
- AV2 - Video source IN ports.
- Video - Video Selecting
- Volume - Audio level Adjustment
- Channel - TV / CATV channel switch



If your remote control doesn't function at all, then these buttons on Box front panel will acting as a keypad for your screen menu, see the details on chapter <Panel Control> in this document.

Box Unit [R] Rear Side

All ports allow you to connect differential sources IN/OUT for the TV / Video programs, then turnover VGA Out to your monitor (s). (describe from left to right)

- DC Plug - DC power from the AC Adapter.
- Audio In - Audio source from PC sound card (Optional Connection).
- Audio Out - Audio output to speaker (s).
- VGA In - Port for PC video from your computer (Optional Connection).
- VGA Out - Port for all videos out to your monitor (s).
- S_Video - An impose type video connector from most video sources (Optional connection).
- AV1_R - Analog Video Composite Input in colored Red for right channel on audio (Optional connection).
- AV1_L - Analog Video Composite Input in colored White for left channel audio (Optional connection).
- AV1_Video - Analog Video Composite Input in colored Yellow for video signal (Optional connection).
- TV ANT / CABLE - port for TV Antenna or CABLE TV (CATV) signal input.

(If you have loss signal on UHF/VHF/FM, you may use signal amplifier to boost receiving "F" type signal in clear levels. Signal amplifier is sold separately, and it is available in most TV/Radio stores.)

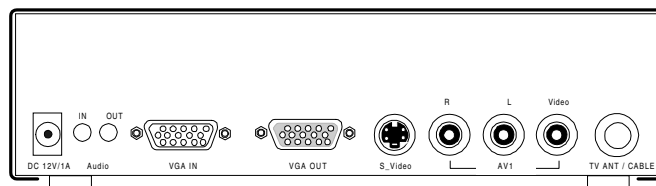

Rear Side Diagram.

Basic Connection X-media DreamBox

The basic connection only plug your monitor to the VGA out port, plug Audio out to your speaker(s) and then connect AC / DC adapter from AC outlet to DC port on this unit. Either TV Antenna or Cable TV connector should be plugged to the unit before you turn the power on.

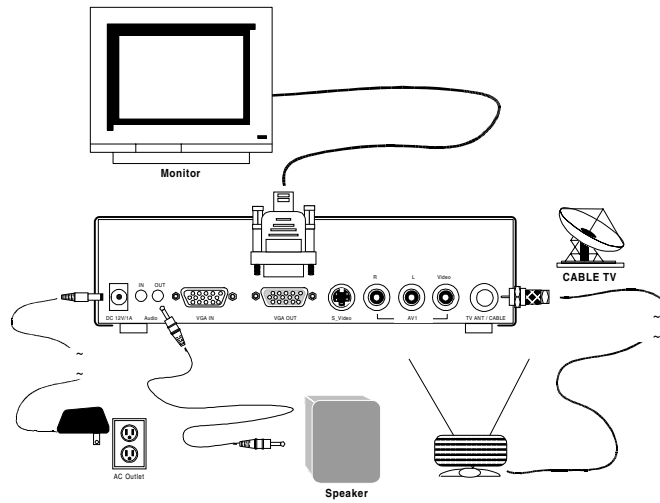

This connection is a simply TV-to-Monitor. The monitor screen as a single display for your TV or CATV program. Both RGB and LCD can display in full screen.

Optional Connection X-media DreamBox

Certainly, you can plugged all kinds differential I/O into this unit to performing more video / audio action accomplishment than just watch TV on your monitor. In advanced connections, all ports on front and rear sides are optional and available for your game console, camcorder, DVD video player, also you can simultaneously working with your computer and have another video picture-in-picture (PIP).

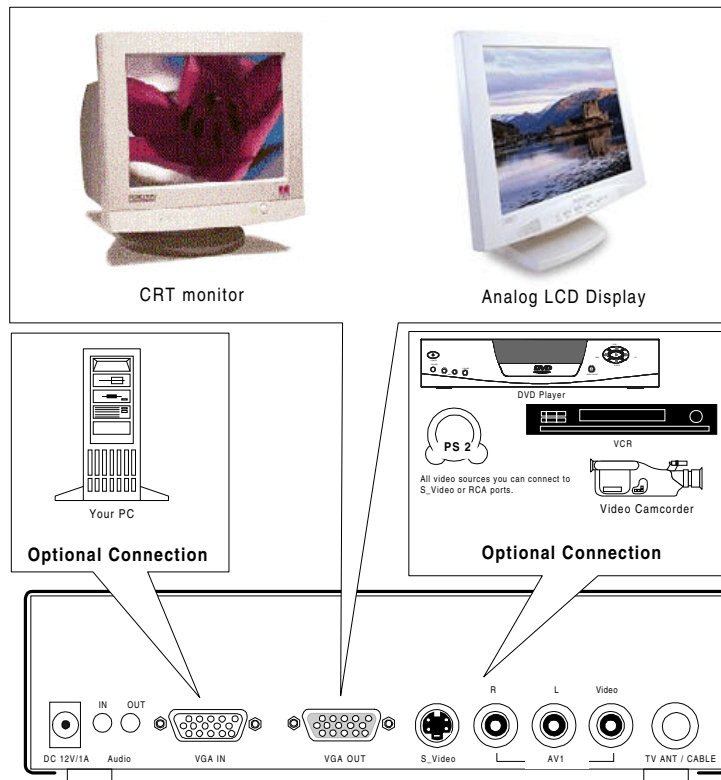



Optional connection as shown as above, which gives you more ideas to add more video sources to this unit, and there is no doubt about this unit capable of handling all of those functions as well. This is a Plug-n-Play unit without any software not even the Microsoft windows.

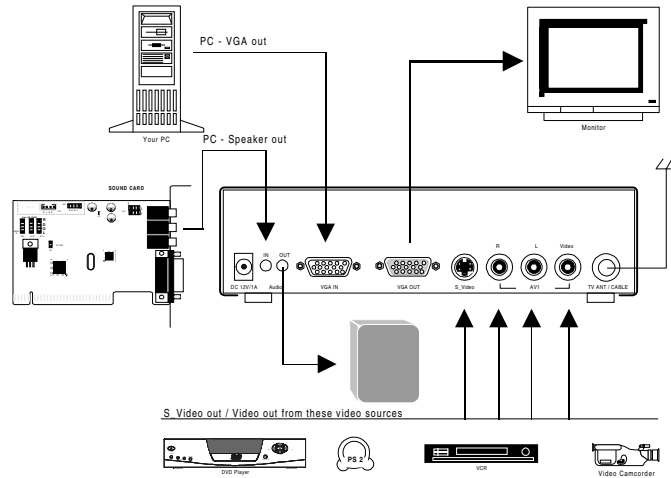

Connection Diagram - 1.

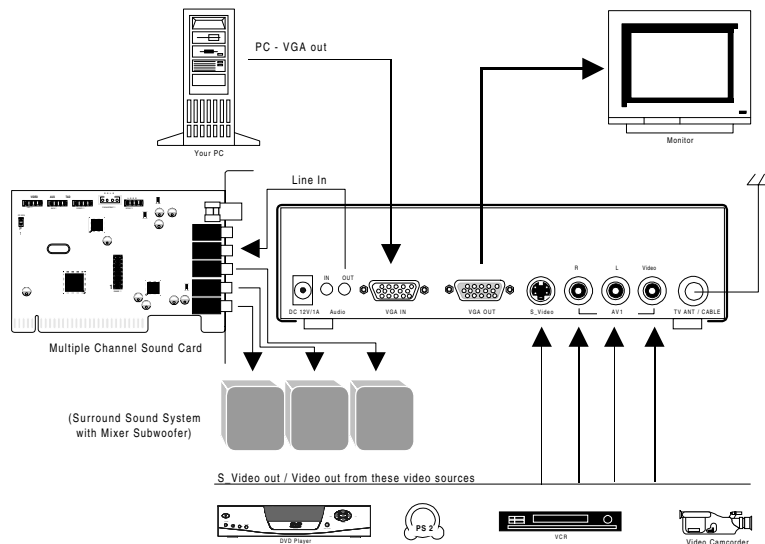

Connection Diagram - 2.

The first connection it described above, the audio out is straight from the source to speaker even without turn on your PC, there are two channels in stereo.

If your connection as second diagram illustrated above for surround sound output, then your PC must be turned on to keeping the multiple channels sound card activate for operation.

AV2 ports at front side on this unit are the optional connections for you playing video programs on tap from VCR/Camcorder to your PC monitor, also adapted for Game console input.



VCR

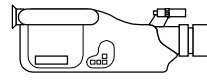

Camcorder



Game Console

- Colored Red Jack - Audio right channel.
- Colored White Jack - Audio left channel.
- Colored Yellow Jack - Video channel.

Remote control	Description
----------------	-------------

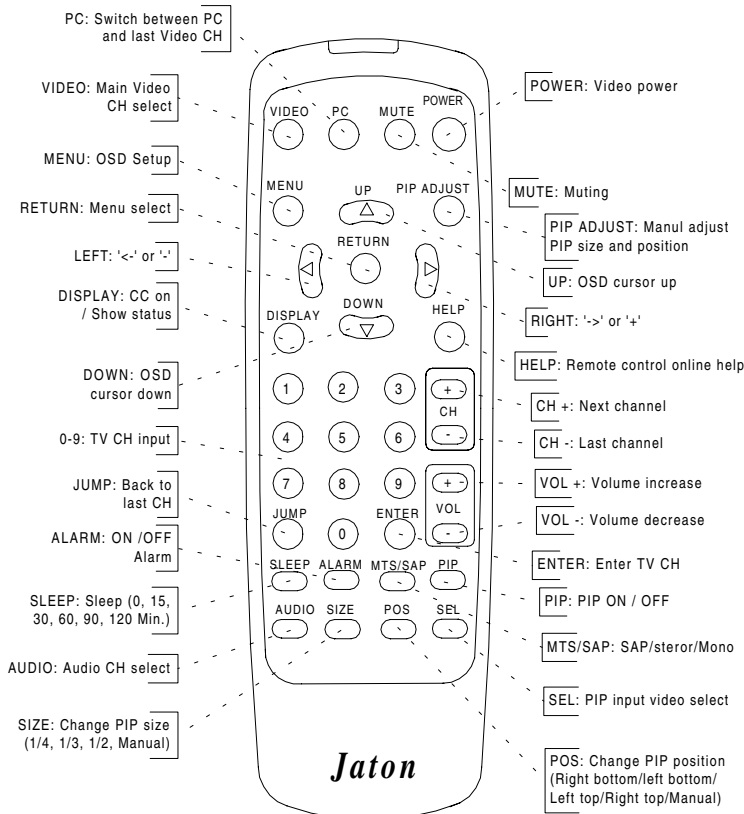

Definition:

- OSD On Screen Display (screen menu)
- PIP Picture-In-PC (Video overlay top on your PC video)
- CH Channel of Audio / Video
- POS Position
- SEL Select
- CC Closed Caption



OSD Menu on your screen

Before you ready to setup OSD menu, make sure you have power-up this unit and other devices you wish to use with. Of course, your monitor must be turn on.

Press “Menu” key: use “up” & “down” for pull-down-list items selected, “left” and “right” key will loop on top bar menu selecting from left to right, all items selecting by highlight in blue color.

Video 1

< Top Bar Menu >

VIDEO 1	2	AUDIO	CLOCK	SETUP	SVGA	TV
----------------	----------	--------------	--------------	--------------	-------------	-----------

Video Color / Display Setting

< PULL DOWN LIST >	<table style="width: 100%;"> <tr> <td style="width: 30%;">RED</td> <td style="width: 30%;"></td> <td style="width: 40%;"></td> </tr> <tr> <td>GREEN</td> <td></td> <td></td> </tr> <tr> <td>BLUE</td> <td></td> <td></td> </tr> <tr> <td>BRIGHTNESS</td> <td></td> <td></td> </tr> <tr> <td>CONTRAST</td> <td></td> <td></td> </tr> <tr> <td>SATURATION</td> <td></td> <td></td> </tr> <tr> <td>HUE</td> <td></td> <td></td> </tr> </table>	RED			GREEN			BLUE			BRIGHTNESS			CONTRAST			SATURATION			HUE			press on left or right key to adjust value, or turn ON/OFF on specific function in each pull down item.
RED																							
GREEN																							
BLUE																							
BRIGHTNESS																							
CONTRAST																							
SATURATION																							
HUE																							

->, <- up, down: Select / Adjust
Menu: Exit

The remote control must be pointing to the unit box, not to your monitor if they were in separate places.

Video 2

< Top Bar Menu >

VIDEO 1	2	AUDIO	CLOCK	SETUP	SVGA	TV
----------------	----------	--------------	--------------	--------------	-------------	-----------

Advanced Video Setting

< PULL DOWN LIST >	<table style="width: 100%;"> <tr> <td style="width: 30%;">Y / C</td> <td style="width: 30%;">0 - 7</td> <td style="width: 40%;">(0 - Default)</td> </tr> <tr> <td>DTFNR</td> <td>LOW / MID / HIGH / OFF</td> <td>(LOW - Default)</td> </tr> <tr> <td>GAMMA</td> <td>ON / OFF</td> <td></td> </tr> <tr> <td>DCTI</td> <td>ON / OFF</td> <td></td> </tr> <tr> <td>DLTI</td> <td>ON / OFF</td> <td></td> </tr> <tr> <td>MDETECT</td> <td>ON / OFF</td> <td></td> </tr> <tr> <td>ASPEC RATIO</td> <td>4x3 / 16x9</td> <td>(4x3 - Default)</td> </tr> <tr> <td>SIGNAL TYPE</td> <td>NTSC / PAL</td> <td>(NTSC - Default)</td> </tr> </table>	Y / C	0 - 7	(0 - Default)	DTFNR	LOW / MID / HIGH / OFF	(LOW - Default)	GAMMA	ON / OFF		DCTI	ON / OFF		DLTI	ON / OFF		MDETECT	ON / OFF		ASPEC RATIO	4x3 / 16x9	(4x3 - Default)	SIGNAL TYPE	NTSC / PAL	(NTSC - Default)	press on left or right key to adjust value, or turn ON/OFF on specific function in each pull down item.
Y / C	0 - 7	(0 - Default)																								
DTFNR	LOW / MID / HIGH / OFF	(LOW - Default)																								
GAMMA	ON / OFF																									
DCTI	ON / OFF																									
DLTI	ON / OFF																									
MDETECT	ON / OFF																									
ASPEC RATIO	4x3 / 16x9	(4x3 - Default)																								
SIGNAL TYPE	NTSC / PAL	(NTSC - Default)																								

->, <- up, down: Select / Adjust
Menu: Exit

- Y/C - V-size / Center screen Adjustment
- DTFNR - Dynamic Temporal frame-Filtering Noise Reduction
- DCTI - Dynamic Chrominance Transience Improvement
- DLTI - Dynamic Luminance Transience Improvement
- MDETECT - Motion Detection



Audio

< Top Bar Menu >

VIDEO 1	2	AUDIO	CLOCK	SETUP	SVGA	TV
---------	---	--------------	-------	-------	------	----

Audio Setting

< PULL DOWN LIST >	VOLUME ██████████░░░░░░░░	} press on left or right key to adjust value, or turn ON/OFF on specific function in each pull down item.
	BASS ██████████░░░░░░░░	
	TREBLE ██████████░░░░░░░░	
	LOUDNESS ██████████░░░░░░░░	
	MUTE ON / OFF (OFF - Default)	

->, <- up, down: Select / Adjust Menu: Exit

Clock

< Top Bar Menu >

VIDEO 1	2	AUDIO	CLOCK	SETUP	SVGA	TV
---------	---	-------	--------------	-------	------	----

Clock / Alarm Setting

< PULL DOWN LIST >	SLEEP MODE OFF / 15 Min. / 30 Min. / 60 Min. / 90 Min. / 120 Min.	} press on left or right key to adjust value, or turn ON/OFF on specific function in each pull down item.
	SET TIME 00:00 (Selectable on AM or PM)	
	SET ALARM 00:00 (Selectable on AM or PM)	
	ALARM SOURCE 1 - 125 (Number of your TV or CATV Channel)	
	ALARM TIMER ON / 10 Min. / 30 Min. / 60 Min. / OFF	

->, <- up, down: Select / Adjust Menu: Exit



Recommended Refresh Rate-display monitor resolution support.

Resolution (Pixel)	Refresh Rate (Hz)
640 x 480	60, 72, 75
800 x 600	60, 72, 75
1024 x 768	60, 72

TV

< Top Bar Menu >

VIDEO 1	2	AUDIO	CLOCK	SETUP	SVGA	TV
---------	---	-------	-------	-------	------	-----------

ADVANCED TV SETTING

< PULL DOWN LIST >	CATV	ON / OFF	} press on left or right key to adjust value, or turn ON/OFF on specific function in each pull down item.
	AUTO PROGRAM	OFF > (If this function is on, all TV channels are scanned.)	
	MTS	STEREO / SAP / MONO	
	CH ADD	3 > (OK) (You may use 0-9 key to add new TV channel.)	
	CH ERASE	3 > (OK) (You may use 0-9 key to erase TV channel.)	

→, ←, up, down: Select / Adjust Menu: Exit

Panel Control

Front Side Key Map

There is another way to display OSD Menu on your monitor without the Remote Control (If you temperately loss it, or low on battery).

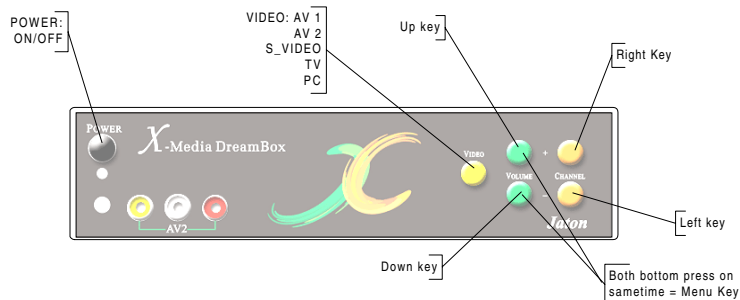

Turn on your monitor, then press "Power" button on this unit (If power LED was orange). Use both "Volume" up & down buttons to brings-up OSD menu to your monitor, if the image screen doesn't clear then you may use "Video" button to switch the mode you are expecting so.



TROUBLESHOOTING

If power button doesn't bring the power up to this unit, try to unplug the AC/DC adapter from AC outlet then plug again, and make sure that outlet is active.

Should any problem persist, consult your nearest JATON dealer.

For technical support, email to cesupport@jaton.com or call Customer Service at (408) 934-9369

Glossary

Definition

Automatic Gain Control (AGC)

AGC is a circuit designed to boost the amplitude of a signal to provide adequate levels of recording.

Aspect Ratio

The width to height ratio of an image. A 4:3 aspect ratio means the horizontal side is a third wider than the vertical size. Standard television ratio is 4:3 (or 1.33:1). Wide-screen DTV and HDTV aspect ratio is 16:9 (or 1.78:1).

Alpha Blending

This is the way of combining two images by blending together at factor of alpha. Alpha denotes the blending factor.

Caption

A textual representation of the audio information in a video program. Captions are usually intended for the hearing impaired, and therefore include additional text to identify the person speaking, off screen sounds, etc.

Chroma

The color component of a video signal, independent of the luma.

Chrominance

The color component (hue and saturation) of light independent of luminance. Technically, Chrominance refers to the linear component of video, as opposed to the transformed non-linear chroma component.

Cinema Mode

Cinema mode aspect ratios are slightly wider than standard TV modes. Common film aspect ratios are 1.85:1 and 2.35:1. Sometimes referred to as Theater modes.

Closed Caption

Text caption for video which are not normally visible, as opposed to open caption, which are a permanent part of the picture. In the United States, the official NTSC Closed Caption standard requires that all TVs larger than 13" include circuitry to decode and display caption information stored on the line 21 of the video signal.

Component Video

A video system containing three separate color component signals, either Red/Green/Blue (RGB) or Chroma/color differences (YCbCr, YPbPr, YUV), in analog or digital form.

Composite Video

An analog video signal in which the luma and chroma components are combined (by frequency multiplexing), along with sync and burst. Also called CVBS.

Dynamic Luminance Transience Improvement

It is a content adaptive horizontal peaking for the luma signal to improve the visual quality of TV picture.

Dynamic Chrominance Transience Improvement



Assuming luma and chroma transitions are normally aligned, the chroma transition are usually degraded due to narrow bandwidth of chroma information. By monitoring coincident luma transient, a faster edge is synthesized for the chroma transitions. This edge then is aligned with the luma edge.

Dynamic Scan Velocity Modulation (DSVM)

DSVM constantly monitoring the edge information of the picture while simultaneously modifying the speed of the electron beam as it scans the picture tube.

DSVM ensures sharper picture details are retained when there are edges in the picture.

Dynamic Digital Comb Filter (DDCF)

The adaptive comb filter is used for high quality Y/C separation for both PAL and NTSC signals. The adaptive comb filter can improve luma resolution and reduces cross talk between luma and chroma.

Dynamic Adaptive Static Detect De-interlacing

Improves the clarity and sharpness of the overall picture by enhances the "non-moving" portions of the picture by doubling the resolution of those areas. This unique feature is enabled by utilizing Trident's proprietary technology.

Dynamic Temporal frame-Filtering Noise Reduction

The motion adaptive non-linear Infinite Impulse Response (IIR) filter is used to reduce the luminance noise. The amount of noise reduction is controlled by the motion picture which remove the tailing effect when there is motion in the picture.

Digital Television (DTV)

In general, any system that encodes video and audio in digital form. In specific, the Digital Television System proposed by the ATSC or the digital TV standard proposed by the Digital TV Team founded by Microsoft, Intel and Compaq.

Dynamic Gamma Control

It is the same as Dynamic Brightness/Contrast Adjustment.

Dynamic Black Level eXtender (DBLX)

The DBLX extends gray to black level to improve the contrast of the TV picture.

Dynamic Brightness/Contrast Adjustment

This is an artificial intelligent type of algorithm. The DPTV and micro controller will adaptively adjust the contrast and brightness of picture depending on the picture content.

Dynamic Adaptive Smoothing Filter

To remove the high frequency noise in TV picture.

Dynamic Frame/Scan Rate Converter

The DPTV can convert input TV signal to any refresh rate. For example, it can convert from 50Hz PAL timing to 75Hz non-interlaced output or from 50Hz timing to 100Hz interlaced output.

Dynamic White Peak Level Restriction

Dynamically limits white level of image.

Dynamic Skin Color Correction

Depending on picture content, the DPTV will dynamically change the gain of U and V channels to make colors on picture more vivid.

Dynamic Digital SVGA Overlay

The DPTV can capture SVGA RGB data into frame buffer. It can be scaled to any size and overlay with TV picture.



Gamma Correction

The characteristics of the displays using phosphors (as well as some cameras) are non-linear. A small change in voltage when the voltage level is low, produces a change in output display brightness. The same small voltage change at high voltage level will not produce the same magnitude in output brightness. This effect or the difference between what you should have and what you actually measured is known as gamma. Gamma correction is to process RGB signals to compensate for the gamma of display.

High-Definition Television (HDTV)

A video format with a resolution approximately twice that of the conventional television in both the horizontal and vertical dimensions, and a picture aspect ratio of 16:9. Used loosely to refer to the US DTV system.

Improved-Definition Television (IDTV)

A television receiver that improves the apparent quality of the picture from a standard video signal by using techniques such as frame doubling, line doubling, and digital signal processing.

Interlaced

A video scanning system in which alternating lines are transmitted, so that half a picture is displayed each time the scan beam moves down the screen. An interlaced frame is made of two fields.

Luma

The brightness component of a color video image (also called the grayscale, monochrome, or black-and-white component). Non-linear luminance.

Luminance

Loosely, the sum of RGB tristimulus values corresponding to brightness. May refer to a linear or non-linear signal.

Moving Pictures Expert Group (MPEG)

An international committee that developed the MPEG family of audio and video compression systems.

On-Screen Display (OSD).

OSD is a means of displaying system status by overlaying the information over the picture on the viewing screen directly. Users can choose to implement text-based or Graphical based OSD

Panorama

A video image that uses non-linear distortion to stretch the sides more and the center less, thus minimizing the apparent distortion. This feature is found on some wide-screen television.

Picture-Outside-Picture (POP)

A feature of some wide-screen displays that uses the unused area around a 4:3 picture to show additional pictures.

Picture-in-Picture (PIP)

A feature of some televisions that shows another channel or video source in a small window superimposed in a corner of the screen.

Programmable Zoom Viewer

TV picture can be scaled up or down with any factor.

Progressive Scan

A video scanning system that displays all lines of a frame in one pass. Contrast with interlaced scan.

Standard Definition Television (SDTV)

A term applied to traditional 4:3 television (in digital or analog form) with a resolution of about 700x480 (about 1/3 megapixel).



S-Video

A video interface standard that carries separate luma and chroma signals, usually on a four-pin mini-DIN connector. Also called Y/C. The quality of s-video is significantly better than composite video since it does not require a comb filter to separate the signals, but it is not quite as good as component video. Most high-end televisions have s-video inputs.

Sequential color with memory (SECAM)

A composite color standard similar to PAL, now currently used only as a transmission standard in France and a few other countries. Video is produced using the 625/50 PAL standard and is then transcoded to SECAM by the player or transmitter.

Tristimulus

A three-valued signal that can match nearly all colors of the visible light in human vision. This is possible because of the three types of photoreceptors in the eye.

Vertical Blanking Interval (VBI)

The scan lines in a television signal that do not contain picture information. These lines are present to allow the electron scanning beam to return to the top and are used to contain auxiliary information such as closed caption.

Widescreen TV

A video image wider than the standard 4:3 aspect ratio. When referring to DVD or HDTV, wide-screen usually implies a 16:9 aspect ratio.

Limited Warranty.

These limited warranties extend to original consumer purchaser or any person receiving this set as a gift from the original consumer purchaser and to no other purchaser or transferee.

Limited Ninety (90) Day Warranty

JATON warrant this product against defects in materials or workmanship for a period of ninety (90) days after the date of original retail purchase. During this period, JATON will repair or replace a defective product or part, at their option, with a new or refurbished product or part without charge to you. You must deliver the entire product to JATON or a JATON Authorized Service Station. You are responsible for all transportation and insurance charges for the unit to and from the Authorized Service Station.

Limited One (1) Year Warranty

JATON further warrant the parts in this product against defects in materials or workmanship for a period of one (1) year after the date of original retail purchase. During this period, JATON will repair or replace a defective product or part, at their option, with a new or refurbished product or part without charge to you, except that if a defective part is replaced after ninety (90) days from the date of the original retail purchase you pay labor charges involved in the replacement. You must also deliver the entire product to JATON or a JATON Authorized Service Station. You are responsible for all transportation and insurance charges for the unit to and from the Authorized Service Station.

Rental Units

The warranty for rental units begin with the first rental or thirty (30) days from the date of shipment to the rental firm, whichever comes first.



Commercial Units

Products sold and used for commercial use have a limited ninety (90) day warranty for all parts and labor.

Register Product

You should read the owner's manual thoroughly before operating this product. You should complete and mail the enclosed Registration card within thirty (30) days after you, or the person who has given you this product as a gift, purchased this product. This is one way to enable JATON to provide you with better customer service and improved products. Failure to return the card will not affect your rights under this warranty.

Your Responsibility

The above warranties are subject to the following conditions:

1. You must retain your bill of sale or provide other proof of purchase.
2. You must notify JATON or a JATON Authorized Service Station within thirty (30) days after you discover a defective product or part.
3. All warranty servicing of this product must be made by JATON or a JATON Authorized Service Station.
4. JATON warranties are effective only if the product is purchased and operated in the same continent territorial regions.
5. Labor service charges for set installation. Set up, adjustment of customer controls and installation or repair of antenna systems are not covered by this warranty. Reception problems caused by inadequate antenna systems are your responsibility.
6. Warranties extend only to defects in materials or workmanship as limited above and do not extend to any product or parts which have been lost or discarded by you or to damage to products or parts caused by misuse, accident, damage caused by Acts of God, such as lightning or fluctuations in electric power, improper installation, improper maintenance or use in violation of instructions furnished by us; or to units which have been altered or modified without authorization of JATON or to damage to products or part thereof which have had the serial number removed, altered, defaced or rendered illegible.
7. Physically damaged this unit, or remote control is not acceptable for repair or exchange whether in or out of warranty and will be returned as received.

All warranties implied by state law, including the implied warranties of merchantability and fitness for a particular purpose, are expressly limited to the duration of the limited warranties set forth above. With the exception of any warranties implied by state law as hereby limited, the foregoing warranty is exclusive and in lieu of all other warranties, guarantees, agreements and similar obligations of manufacturer or seller with respect to the repair or replacement of any parts. In no event shall JATON be liable for consequential or incidental damages.

No person, agent, distributor, dealer or company is authorized to change, modify or extend the terms of these warranties in any manner whatsoever. The time within which an action must be commenced to enforce any obligation of JATON arising under the warranty or under any statute, or law of the United States or any state thereof, is hereby limited to ninety (90) days from the date you discover or should have discovered, the defect. This limitation does not apply to implied warranties arising under state law.

This warranty gives you specific legal rights and you may also have other rights which may vary from state to state. Some states do not allow limitation on how long an implied warranty lasts, when an action may be brought, or the exclusion or limitation of incidental or consequential damages, so the above provisions may not apply to you.

